

**Slide & Chamber**

\* Read this instruction manual before use and keep it safe.

Cat.No.	Product Name	Sterilization	Working Volume (Max. Volume)	Culture Area per well
192-008	Slide & Chamber 8well	Sterile (EOG)	0.35ml~0.6ml (1.0ml)	70mm <sup>2</sup>
192-004	Slide & Chamber 4well	Sterile (EOG)	0.7ml~1.4ml (2.0ml)	170mm <sup>2</sup>
192-002	Slide & Chamber 2well	Sterile (EOG)	1.4ml~2.4ml (4.0ml)	400mm <sup>2</sup>

\* Working Volume is 35%-60% of the maximum volume.



**Precautions**

- The glass may break if you use excessive force when removing the hook. Be careful with the force you use to hold the glass.
- Handle the silicon gasket gently when you remove it with tweezers. The silicon gasket may break if it is handled roughly.
- Press a cover glass gently to eject as much air as possible when you seal a sample. Excessive force may break the cover glass.
- Do not use this product for other purpose than research.
- Use gloves and a face mask when you work with this product.

**Product configuration**

Cover (PS)

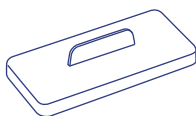

Hook (PP)

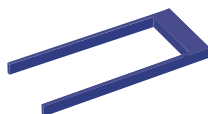

Chamber (PP)

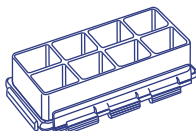

Gasket

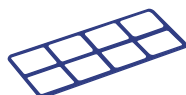

Slide glass

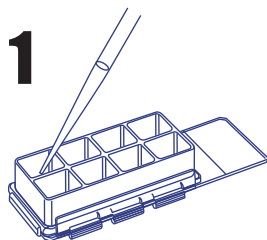
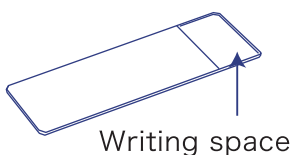

1 Dispense a sample into wells, place the cover on it, incubate, and immunostain.

2 Remove the hook after immunostaining.

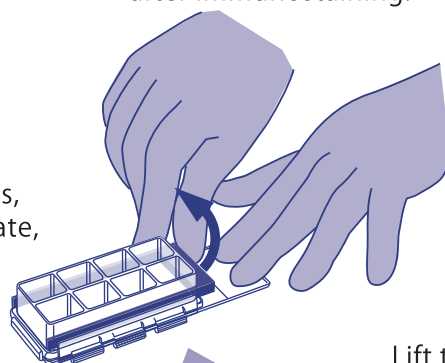

Lift the hook to remove.

3 Remove the chamber from the slide glass.

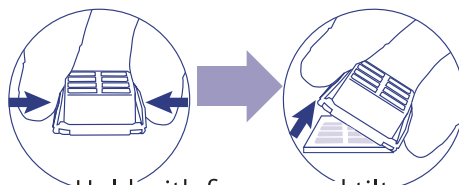

Hold with fingers and tilt.

4 Prepare separately a cover glass (24mm x 55mm) and seal the sample.

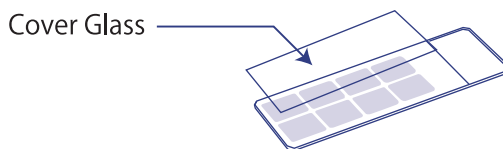

Manufactured and sold by:

**FUKAEKASEI** CO., LTD.

Head Office: 2-2-7 Murotani, Nishi-ku, Kobe

651-2241, JAPAN

TEL +81-78-991-4477

FAX +81-78-991-4491

E-mail: [info@watson.co.jp](mailto:info@watson.co.jp)

<https://watsonbiolab.com>

Something Different.

**WATSON** BIO LAB  
MADE IN JAPAN SINCE 1988